

# Autosteamer

## Utilizzo

Il sistema autosteamer permette di schiumare il latte e di portarlo ad una temperatura programmabile.

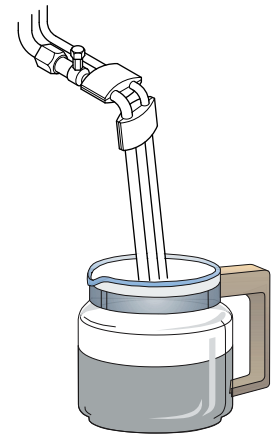

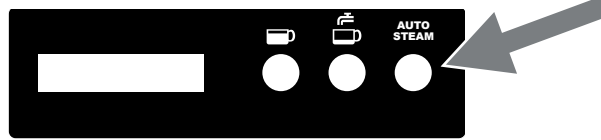



- 1) Immergere i terminali dell'autosteamer nella bevanda da riscaldare;
- 2) Premere il tasto autosteamer;
- 3) Attendere fino al completamento dell'erogazione di vapore.



Per bloccare anticipatamente l'erogazione, premere nuovamente il tasto autosteamer.

Mantenendo premuto il tasto autosteamer è possibile prolungare l'erogazione di vapore oltre la temperatura programmata.

## Regolazione temperatura

- Posizionare l'interruttore di programmazione in **ON** (  lampeggiate sul display). L'interruttore è collocato sotto il frontale nella parte destra della macchina.
- Mantenere premuto il tasto  per 5 secondi
- Premere ripetutamente il tasto  finchè sul display appare il seguente messaggio 
- Mediante i tasti   modificare la temperatura dell'autosteamer visualizzata a display
- Al termine della programmazione riposizionare l'interruttore di programmazione in **OFF**

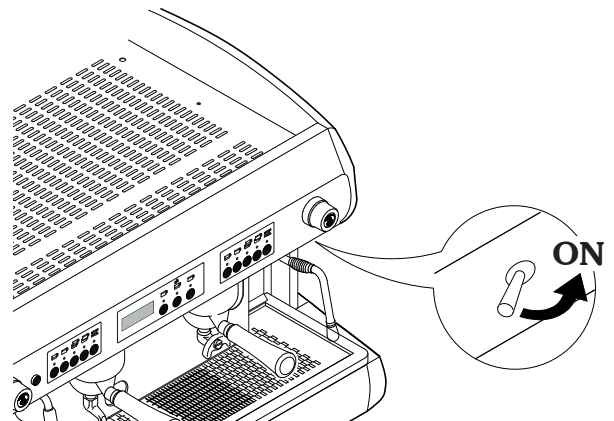

## Regolazione schiumatura latte

Per regolare la schiumatura del latte procedere come segue:

- Mediante una chiave svitare il componente **(A)** della lancia vapore
- Tramite un cacciavite agire sulla vite **(B)** posta all'interno del particolare:
  - per ridurre la schiumatura girare in senso orario
  - per aumentare la schiumatura girare in senso antiorario

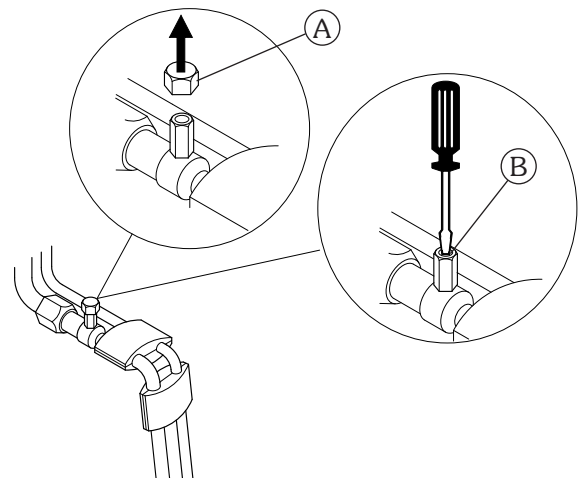

Il sistema prevede un time-out di funzionamento massimo di 4 minuti dell'autosteamer.

Per mantenere sempre in perfetta efficienza gli erogatori di vapore, si consiglia di effettuare una breve erogazione a vuoto al termine di ogni utilizzo. Tenere costantemente puliti i terminali dell'autosteamer mediante un panno inumidito in acqua tiepida. Prestare la massima attenzione nell'impiego dell'autosteamer per il pericolo dovuto alla presenza di vapore ad alta temperatura.

# Autosteamer

## Use



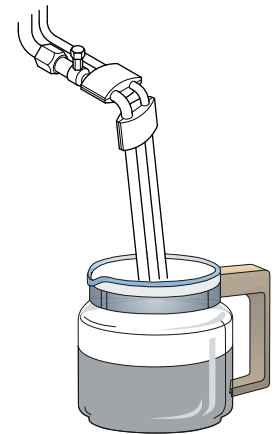
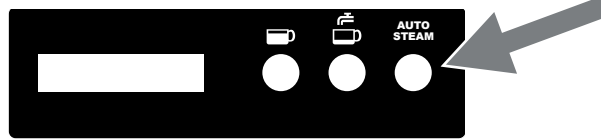

The autosteamer system makes it possible to make the milk foamy and to bring it up to a programmable temperature.

- 1) Immerse the ends of the autosteamer into the beverage to be heated;
- 2) Press the autosteamer key;
- 3) Wait for steam delivery to be completed.



To stop delivery ahead of time, press the selected key again. By holding down the autosteamer key it is possible to extend steam delivery beyond the set temperature.

## Heating temperature adjustment

- Turn the programming switch on **ON** ( **P** flashes on the display).
- Keep the key  pressed for at least 5 seconds
- Repeatedly press the  key until the display shows the message 
- Use the keys   to modify the temperature of the autosteamer shown on the display
- When programming is finished, turn the programming switch on **OFF**

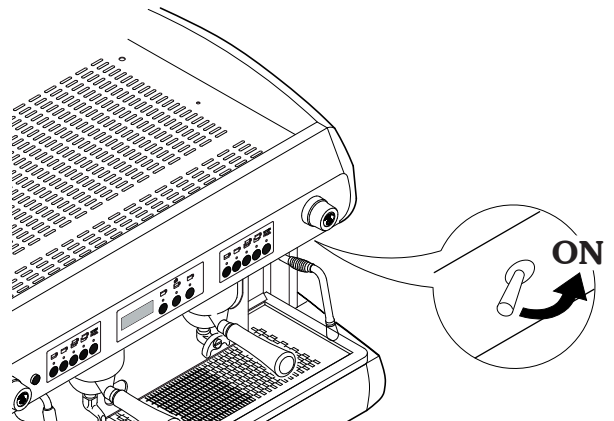

## Milk foaming adjustment

To adjust milk foaming, proceed as follows:

- Use a wrench to unscrew component **(A)** on the steam nozzle
- Use a screwdriver **(B)** located inside the part:
  - to reduce foaming turn clockwise
  - to increase foaming turn counter-clockwise

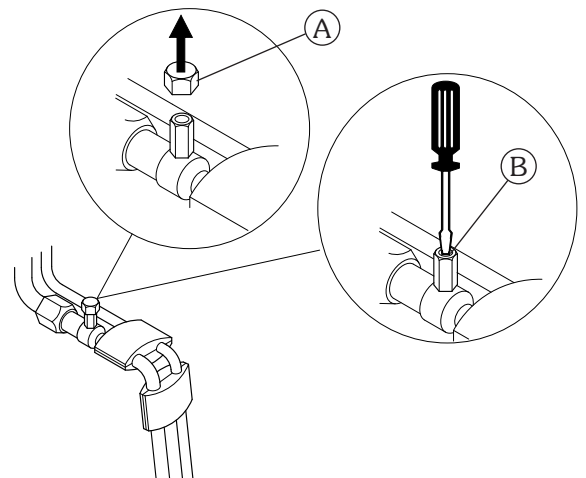

The system includes a maximum operation time of 4 minutes for the autosteamer. To keep the steam dispensers in perfect working order, it is advisable to carry out a delivery dry run after each use. Keep the ends of the autosteamer clean at all times by means of a cloth dampened in lukewarm water. Use the utmost caution with the autosteamer, as high-temperature steam is present.